

# LEVELe™ ELEVATOR INTERIORS

## INSTALLATION INSTRUCTIONS

### INCLUDED

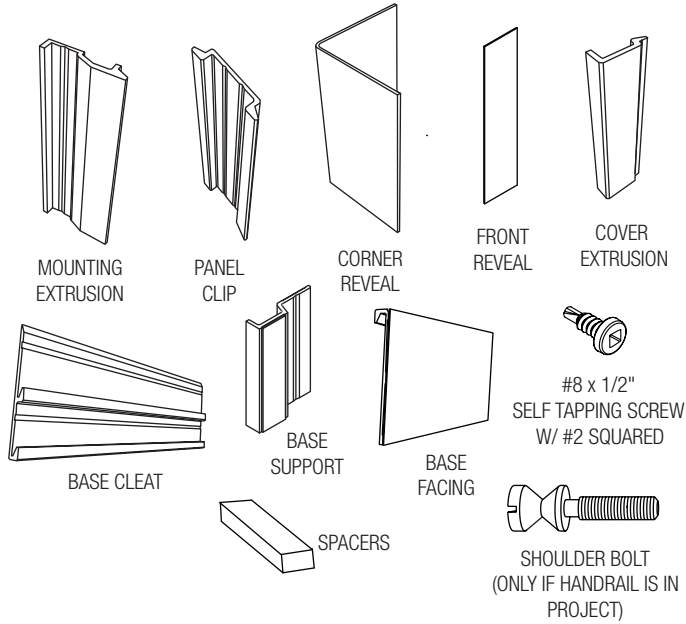

### TOOLS NEEDED

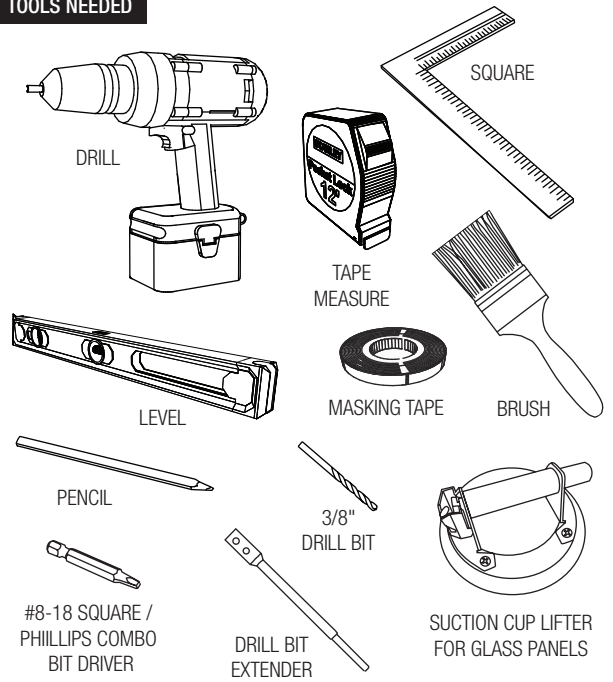

### STEP BY STEP

LEVELe-105 configuration is used in these instructions. Alternate configurations will follow the basics of this installation, with minor adjustments, based on handrail panels, number of panels, and types of panels. Please contact your project manager with questions.

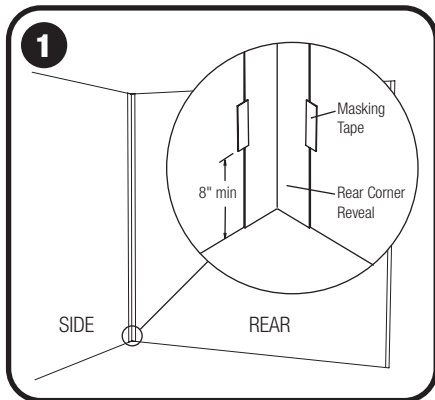

#### Install (2) Corner Reveals.

- Remove protective covering from front of Reveals.
- Place Corner Reveals and attach a piece of masking tape every 4'.
- Cover no more than 1/8" of the reveal with tape.

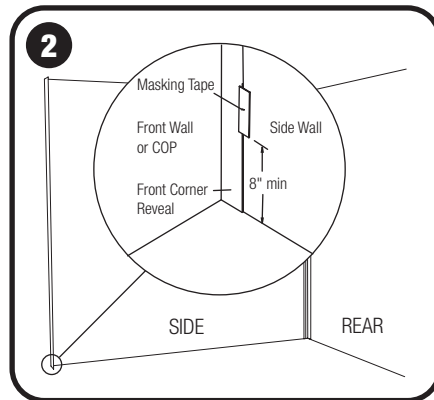

#### Install (2) Front Reveals.

- Remove protective covering from front of Front Reveals.
- Place Front Reveals and attach a piece of masking tape every 4'.
- Cover no more than 1/8" of the reveal with tape.

**Note:** For custom base heights, please refer to the project-specific shop drawings and custom installation instructions.

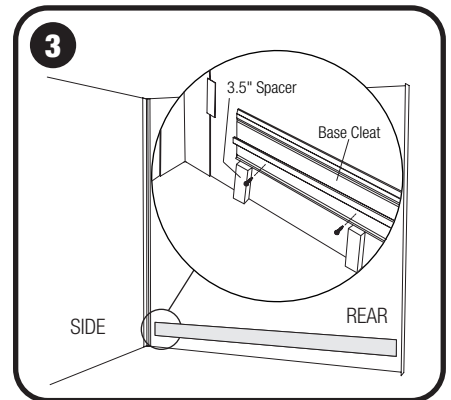

#### Install Base Cleat Extrusions.

- Using the provided spacers for height, position the Base Cleat on the center of the rear wall.
- Ensure the Base Cleat is level before proceeding. For bowed or uneven cab shells, add shims behind the Base Cleat.
- Secure the Base Cleat with the provided self-drilling screws in the lower v-groove, spaced every 18-24".
- Once secure, make sure the Base Cleat is level. Repeat for the remaining side walls.

# LEVELe™ ELEVATOR INTERIORS

## INSTALLATION INSTRUCTIONS

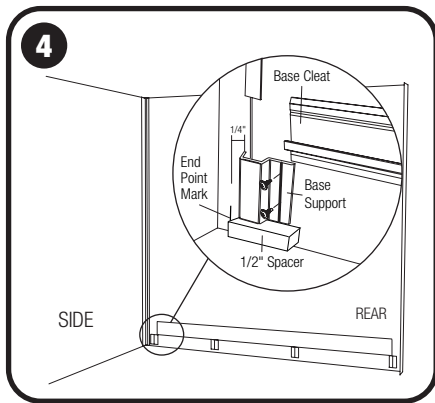

### Install Base Supports.

- Dry fit the Base Facing. Center Base Facing along back wall and hang from clip on Base Extrusion. Mark the locations of both ends along the wall.
- Install the left- and right-most Base Supports approximately 1/4" from your markings and every 18 - 24" in between. Use 1/2" spacer as a guide. Do not hinder airflow.

**Note:** Elevator floor might be uneven. Ensure Base Supports are flush with the bottom of the Base Cleat.

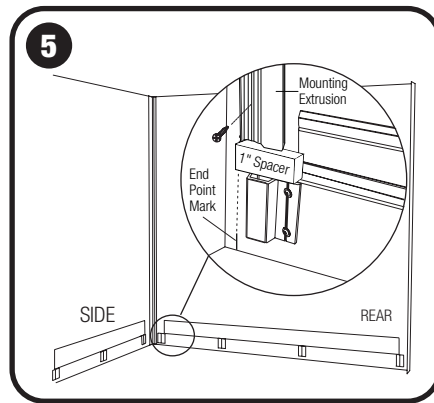

### Install (1) Mounting Extrusion on rear wall.

- On the rear wall, align the Mounting Extrusion vertically with the endpoint marked in the previous step.
- Use the provided 1" spacer above the Base Support to set the Mounting Extrusion at the proper height. **Be sure the Mounting Extrusion is square relative to the base.**
- Attach using provided self-drilling screws. Space screws every 18-24".

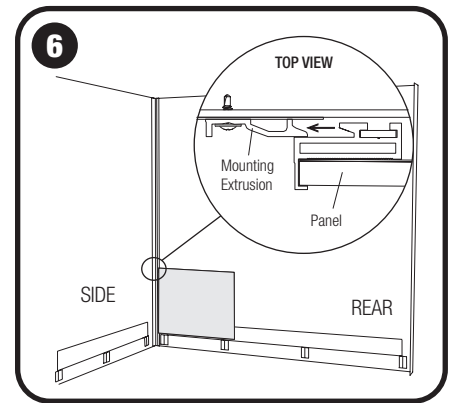

### Install First Panel.

- **Remove debris from Mounting Extrusion and Base Cleat with a brush prior to installation.**
- The first panel will engage into the vertical Mounting Extrusion and Base Cleat. **It is important that lower panels are installed straight and level, and engage fully with the Mounting Extrusion.**
- The panel must engage with the top cleat of the Base Cleat.

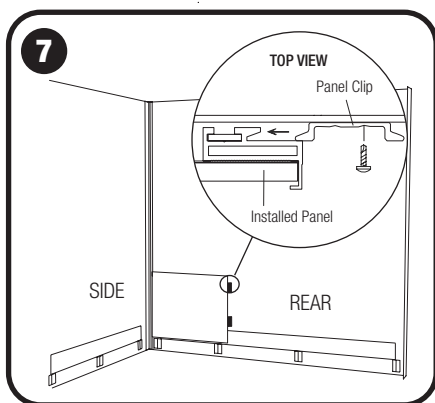

### Attach side Panel Clips.

- Attach the Panel Clips as shown, using the provided self-drilling screws.
- (1) Panel Clip should be installed every 18-24" for proper alignment.

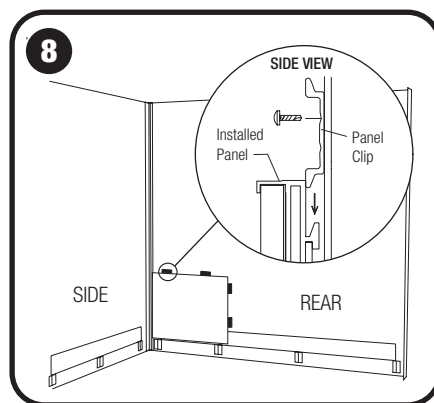

### Attach top Panel Clips.

- Attach the Panel Clips as shown, using the provided self-drilling screws.
- (1) Panel Clip should be installed every 18-24" for proper alignment.

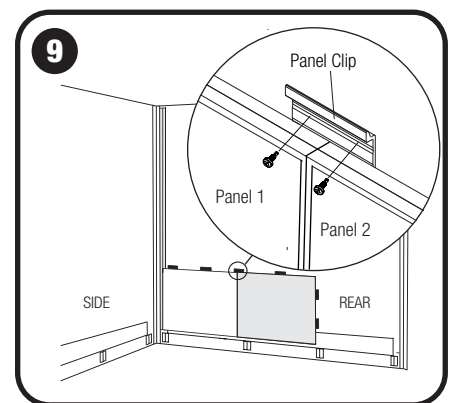

### Install next Panel in sequence.

- Using the installation sequence document provided with your elevator interiors, install panels in the order indicated by using the method described in steps 6-8.
- At any point where two panels meet, Panel Clips should cross over both panels, as seen above, to ensure ideal panel alignment.

# LEVEL<sup>e</sup>™ ELEVATOR INTERIORS

## INSTALLATION INSTRUCTIONS

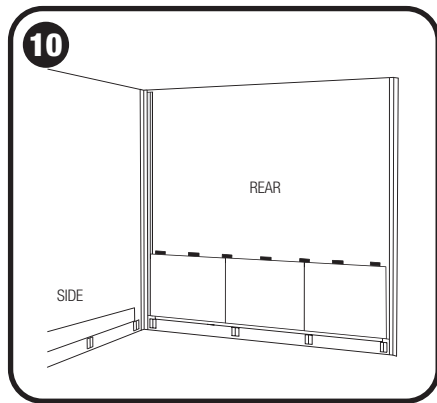

### Repeat steps 6-9 as required.

- No side Panel Clips are installed for last panel of the row.
- Panels must engage fully with Mounting Extrusion and Panel Clips. Debris will prevent the panel from engaging fully.

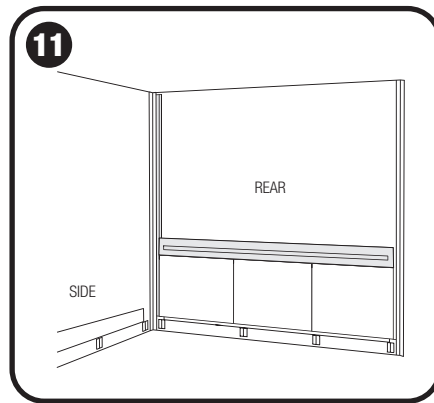

### Install Handrail Panel (if applicable).

- Configurations with a handrail panel come with handrails factory installed on a single panel.
- For configurations with handrails not mounted to panels, Step 20 details this installation.

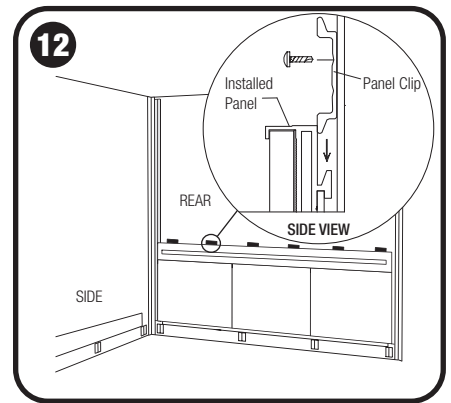

### Install top Panel Clips.

- Attach the clips as shown, using the provided self-drilling screws.
- One Panel Clip should be installed every 18-24" for proper alignment.

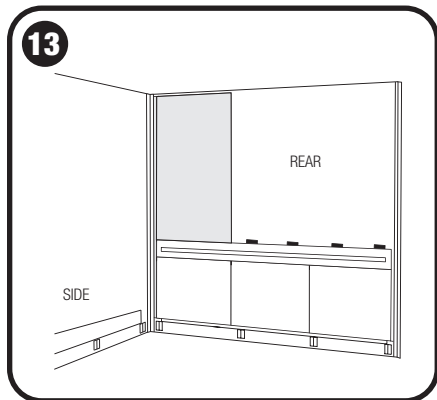

### Continue to Install Panels in sequence.

- **Remove debris from Mounting Extrusion and top Panel Clips with a brush prior to installation.**
- Rest the first upper panel on the top Panel Clips above the handrail panel and engage the side of the panel with the Mounting Extrusion. Refer to step 6 for details.

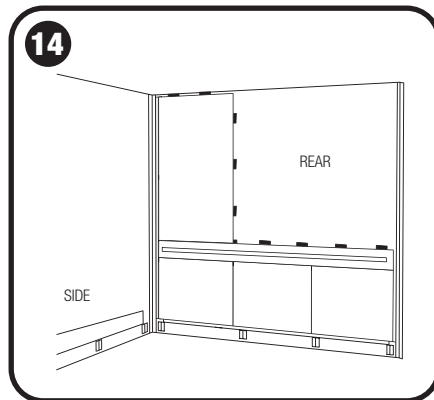

### Install side and top Panel Clips.

- Attach the clips as shown, using the provided self-drilling screws. See steps 7-9 for details.
- (1) Panel Clip should be installed every 18-24" for proper alignment.

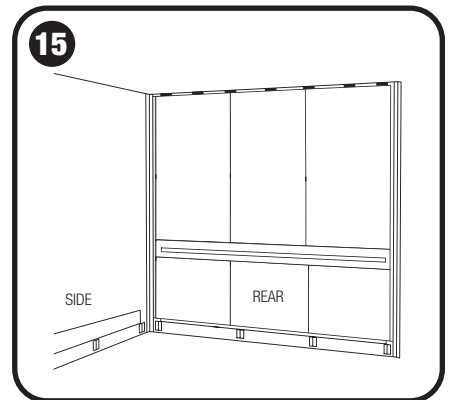

### Repeat steps 13-14 as required.

- No side Panel Clips are installed for last panel in row.

# LEVELe™ ELEVATOR INTERIORS

## INSTALLATION INSTRUCTIONS

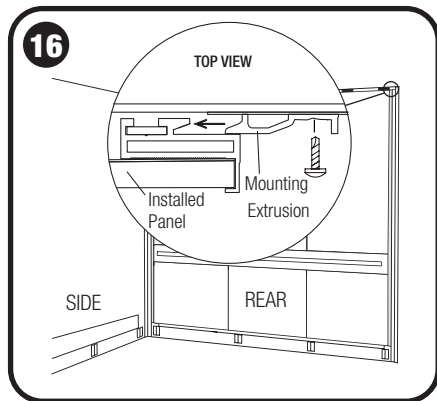

### Install remaining Mounting Extrusions.

- Position Mounting Extrusion and attach using provided self-drilling screws. Space screws every 18-24".
- Mounting Extrusion must fully engage with panels. Rear wall Mounting Extrusions should be equidistant from their respective corners.

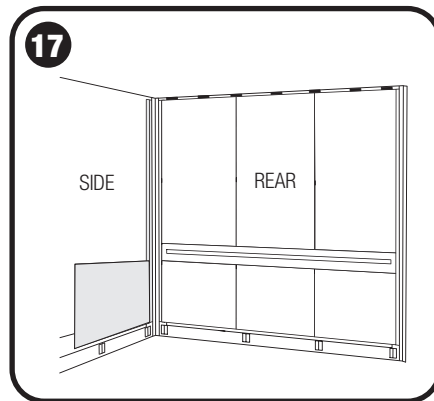

### Repeat steps 6-16 for remaining walls.

- Install all Panels for remaining walls as indicated in previous steps.

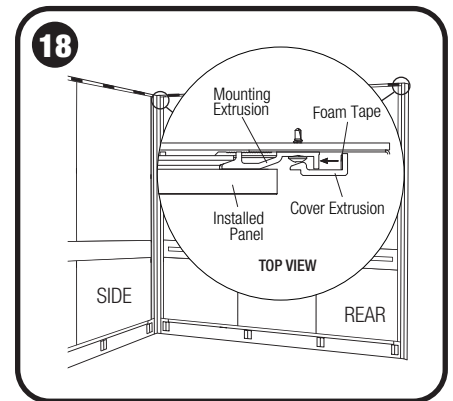

### Install Cover Extrusions.

- Cover the Mounting Extrusion with the Cover Extrusion provided.
- The Cover Extrusion is backed with factory supplied foam tape.

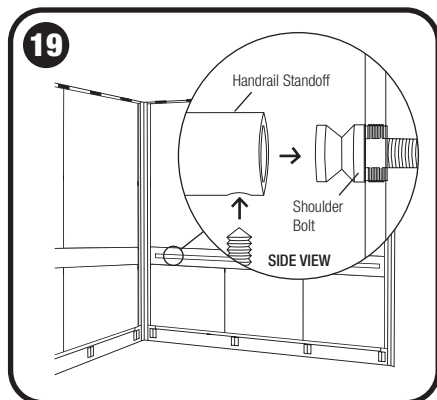

### Install Handrail (if applicable).

- For configurations where handrails span across multiple panels, Shoulder Bolts will be premounted at appropriate locations.
- Once all panels are installed, align the Handrail standoffs with the Shoulder Bolts.
- Slide Handrail onto Shoulder Bolts so the standoffs are flush with the wall panels.
- Tighten the set screws from the underside of the Handrail with the provided allen key.

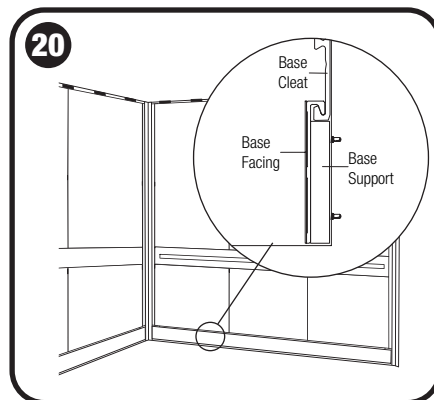

### Install Base Facing.

- Remove backer from VHB tape on front of Base Supports.
- Center Base Facing, aligning with end point markings in Step 4.
- The Base Facing will engage with lower cleat of the previously installed Base Cleat.
- Press firmly to secure Base Facing to VHB tape on Base Supports.